

INSPECTION RECORD

	UNDERGROUND			ROUGH-IN						FINAL		
	Type	Date	By	Type	Date	By	Type	Date	By	Type	Date	By
PLUMBING	Building Drains			Drainage, Waste & Vent Piping	1/30	BD	Indirect Waste			Drainage, Waste & Vent Piping		
	Water Piping									Backflow Prevention		
	Building Sewer			Water Piping	1/30	BD	Condensate Lines			Water Heater		
	Sewer Connection									FINAL APPROVAL	4/2	BD
MECHANICAL	Refrigerant Piping			Refrigerant Piping			Chimney(s)			Grease Exhaust System		
				Duct Furnace(s)			Fire Dampers			Air Cond. Unit(s)		
	Ducts/ Plenums			Ducts/ Plenums			<input type="checkbox"/> Radiant Htr(s) <input type="checkbox"/> Unit Htr(s)			Refrigeration Equipment		
				Duct Insulation			Pool Heater			Furnace(s)		
				Combustion Products Vents			Ventilation <input type="checkbox"/> Supply <input type="checkbox"/> Exhst.			FINAL APPROVAL	4/2	BD
ELECTRICAL	Conduits & or Cable			Conduits/ Cable			<input type="checkbox"/> Range <input type="checkbox"/> Dryer			Temp Service Temp Lighting		
	Grounding & or Bonding			Rough Wiring	1/30	BD	<input type="checkbox"/> Generator(s) <input type="checkbox"/> Motors			Fixtures Lampholders		
	Floor Ducts Raceways			Service Panel Switchboard			<input type="checkbox"/> Water Htr <input type="checkbox"/> Welder			Signs		
	Service Conduit			Busways Ducts			<input type="checkbox"/> Heaters <input type="checkbox"/> Heat Cable			Electric Mtr. Clearance		
	Temporary Power Pole			Subpanels			<input type="checkbox"/> Duct Htr(s) <input type="checkbox"/> Furnace(s)			FINAL APPROVAL	4/2	BD
BUILDING	Location, Set-backs, Esmt(s)			Exterior Wall Construction	1/30	BD	Roof Covering Roof Drainage			Smoke Detector		
	Excavation						Exterior Lath			Demolition (sewer cap)		
	Footings & Reinforcing						<input type="checkbox"/> Interior Lath <input type="checkbox"/> Wallboard					
	Floor Slab			Interior Wall Construction	1/30	BD	Fire Wall(s)			Building or Structure	4/2	BD
	Foundation Walls	1/30	BD	Columns & Supports			Fireplace Chimney					
	Sub-soil Drain			Crawl Space <input type="checkbox"/> Vent <input type="checkbox"/> Access	1		Attic <input type="checkbox"/> Vent <input type="checkbox"/> Access					
	Piles			Floor System(s)	1/30	BD				FINAL APPROVAL BLDG. DEPT.	4/2	BD
			Roof System	1/30	BD	Special Insp Reports Rec'd			Certificate of Occupancy Issued	5/8	BD	
ADDITIONAL	INSPECTIONS, CORRECTIONS, ETC.						INSPECTIONS, CORRECTIONS, ETC.					

APPLICATION FOR
 Residential, Building, Electrical, Plumbing, Mechanical, and Demolition Permit
FROM - The City of Napoleon, Ohio, Building Department
 255 West Riverview Avenue; P.O. Box 151; Napoleon, Ohio 43545 - Telephone (419) 592-4010

ENTRY NO. _____

PERMIT NO. 3571 ISSUED 7-12-95

JOB LOCATION 1120 Lucas St.

LOT 33 Twin Oaks 2nd. Add.
 (Subdivision or Legal Description)

ISSUED BY BMD
 (Building Official)

OWNER Larry Brown PHONE 599-9368

ADDRESS 1120 Woodlawn Napoleon Oh

AGENT Hable Builders PHONE 782-7756

ADDRESS 26761 Behrens Rd. Defiance Ohio

USE: Residential Commercial Industrial
 Other _____

WORK: New Addition Replacement Remodel

ESTIMATED COST = \$ 325,000.00

	Base	Plus	Total
<input checked="" type="checkbox"/> Building	\$ <u>9.00</u>	\$ <u>36.00</u> <u>298.00</u> <u>413.00</u>	\$ <u>422.00</u>
<input checked="" type="checkbox"/> Electrical	\$ <u>15.00</u>	\$ <u>120.00</u>	\$ <u>135.00</u>
<input checked="" type="checkbox"/> Plumbing	\$ <u>9.00</u>	\$ <u>78.00</u>	\$ <u>87.00</u>
<input checked="" type="checkbox"/> Mechanical	\$ <u>36.00</u>	\$ <u>20.00</u>	\$ <u>56.00</u>
<input type="checkbox"/> Demolition	\$ _____	\$ _____	\$ _____
<input type="checkbox"/> Zoning	\$ _____	\$ _____	\$ _____
<input type="checkbox"/> Sign	\$ _____	\$ _____	\$ _____
<input checked="" type="checkbox"/> Water Tap	\$ <u>650.00</u>	\$ _____	\$ <u>650.00</u>
<input checked="" type="checkbox"/> Sewer Tap	\$ <u>272.00</u>	\$ _____	\$ <u>272.00</u>
<input checked="" type="checkbox"/> Temp Water	\$ <u>5.00</u>	\$ _____	\$ <u>5.00</u>
<input checked="" type="checkbox"/> Temp Elec.	\$ <u>10.00</u>	\$ _____	\$ <u>10.00</u>

Additional Plan Review: Structure _____ Hours _____
 Electric _____ Hours _____

TOTAL FEES \$ 1637.00
 Less Fees Paid \$ _____
 BALANCE DUE \$ 1637.00

ZONING INFORMATION

District	Lot Dimensions	Area	Front Yard	Side Yard	Rear Yard
S	150 X 150	22,500	40'	15'	20'

Max Height	No. Pkg. Spaces	No. Ldg. Spaces	Max Cover	Petition or Appeal Required-Date
35'	2 per		30%	

WORK INFORMATION

Building: Ground Floor Area 2567 sq. ft. Basement Floor Area 2567 sq. ft.
 Garage Floor Area 836 sq. ft. 2nd Floor Area 1130 sq. ft. Other Deck + Porches 652 sq. ft.
 Size: Length 78' Width 56' Stories 2 Height 32'
 Building Volume (for Demolition Permit) _____ cubic feet

Description of Work: New Home

ELECTRICAL: Contractor _____ Phone _____

Address _____ ESTIMATED COST = \$ _____

Type of Work: New () Service Change () Rewiring () Add'l Wiring TEMPORARY ELEC. REQUIRED - () Yes () No

Size of Service 200 Underground Overhead _____ Number of New Circuits 40

Description of Work: _____

PLUMBING: Contractor _____ Phone _____

Address _____ ESTIMATED COST = \$ _____

WATER TAP REQUIRED - () Yes () No Size _____ Type of Pipe _____ Water Dist. Pipe _____

SANITARY SEWER TAP REQUIRED - () Yes () No Size _____ Type of Pipe _____ Dr. Waste Vt. Pipe _____

STREET SEWER TAP REQUIRED - () Yes () No Type of Pipe _____ STREET TO BE OPENED - () Yes () No

Main Building Drain Size = _____ Main Vent Pipe Size = _____

LIST NUMBER OF PLUMBING FIXTURES BELOW:

Water Closets = 5 Bathtubs = 2 Showers = 2 Lavatories = 7 Kitchen Sinks = 1 Disposal = 1

Clothes Washer = 1 Floor Drains = 5 Dishwasher = _____ Other 4-1 Basement sink-1 Total = 26

Description of Work: _____

MECHANICAL: Contractor _____ Phone _____

Address _____ ESTIMATED COST = \$ _____

HEATING SYSTEM - () Forced Air () Gravity () Hot Water () Steam () Unit Heaters () Radiant () Baseboard

TYPE OF FUEL - () Electric () Natural Gas () Propane () Wood () Coal () Solar () Geothermal Other _____

NUMBER OF HEAT ZONES = _____ HOT WATER - () One (1) Pipe () Two (2) Pipes () Series Loop

ELECTRIC HEAT - Number of Circuits _____ Number of Furnaces 2 Number of Hot Air Runs 28

Number of Hot Water Radiators _____ Total Heat Loss _____ Rated Capacity of Furnace/Boiler _____

LOCATION OF HEATING UNITS - () Crawl Space () Floor Level () Attic () Suspended () Roof () Outside

Description of Work: _____

DRAWINGS REQUIRED: All applications must be accompanied by two (2) complete sets of Drawings including Site Plans, Foundation Plans, Floor Plans, Structural Framing Plans, Exterior Elevations, Section and Details, Stair Details, Electrical Layout, Plumbing Isometric, Heating Layout, etc. All Plans shall be drawn to scale, show all existing structure on the Site Plans, and show electric panel and furnace locations.

READ AND SIGN BELOW: The undersigned hereby makes application for a Permit for all work described herein and agrees to complete the work in strict accordance with all applicable provisions of the current edition of the C.A.B.O. Building Code, the Napoleon Building and Zoning Codes, the Napoleon Engineering Department Rules and Regulations, Standard Specifications and other pertinent sections of the Napoleon Code of Ordinances.

Signature of Applicant _____ Date _____

ELECTRICAL: Contractor _____ Phone _____
Address _____ ESTIMATED COST = \$ _____
Type of Work: New () Service Change () Rewiring () Add'l Wiring TEMPORARY ELEC. REQUIRED - () Yes () No
Size of Service 200 Underground Overhead _____ Number of New Circuits 40

Description of Work: _____

PLUMBING: Contractor _____ Phone _____
Address _____ ESTIMATED COST = \$ _____

WATER TAP REQUIRED - () Yes () No Size _____ Type of Pipe _____ Water Dist. Pipe _____
SANITARY SEWER TAP REQUIRED - () Yes () No Size _____ Type of Pipe _____ Dr. Waste Vt. Pipe _____
STREET SEWER TAP REQUIRED - () Yes () No Type of Pipe _____ STREET TO BE OPENED - () Yes () No
Main Building Drain Size = _____ Main Vent Pipe Size = _____

LIST NUMBER OF PLUMBING FIXTURES BELOW:

Water Closets = 5 Bathtubs = 2 Showers = 2 Lavatories = 7 Kitchen Sinks = 1 Disposal = 1
Clothes Washer = 1 Floor Drains = 5 Dishwasher = _____ Other 27-1 Basement sink - 1 Total = 26

Description of Work: _____

MECHANICAL: Contractor _____ Phone _____
Address _____ ESTIMATED COST = \$ _____

HEATING SYSTEM - () Forced Air () Gravity () Hot Water () Steam () Unit Heaters () Radiant () Baseboard
TYPE OF FUEL - () Electric () Natural Gas () Propane () Wood () Coal () Solar () Geothermal Other _____
NUMBER OF HEAT ZONES = _____ HOT WATER - () One (1) Pipe () Two (2) Pipes () Series Loop
ELECTRIC HEAT - Number of Circuits _____ Number of Furnaces 2 Number of Hot Air Runs 2A
Number of Hot Water Radiators _____ Total Heat Loss _____ Rated Capacity of Furnace/Boiler _____
LOCATION OF HEATING UNITS - () Crawl Space () Floor Level () Attic () Suspended () Roof () Outside

Description of Work: _____

DRAWINGS REQUIRED: All applications must be accompanied by two (2) complete sets of Drawings including Site Plans, Foundation Plans, Floor Plans, Structural Framing Plans, Exterior Elevations, Section and Details, Stair Details, Electrical Layout, Plumbing Isometric, Heating Layout, etc. All Plans shall be drawn to scale, show all existing structure on the Site Plans, and show electric panel and furnace locations.

READ AND SIGN BELOW: The undersigned hereby makes application for a Permit for all work described herein and agrees to complete the work in strict accordance with all applicable provisions of the current edition of the C.A.B.O. Building Code, the Napoleon Building and Zoning Codes, the Napoleon Engineering Department Rules and Regulations, Standard Specifications and other pertinent sections of the Napoleon Code of Ordinances.

Signature of Applicant _____ Date _____

METER YOKE RELEASE

This document is for the release of **one (1)** Water Meter Yoke for Residential water service lines.

RELEASE NO. 153

PERMIT NO. 3571 ISSUED 7-12-95

JOB LOCATION 1120 Bucca Lane

- Inside City Limits () - Outside City Limits

ISSUED BY Paul Dammann

OWNER Larry Brown

ADDRESS 1120 Woodlawn Way

CONTRACTOR Kable Builders

ADDRESS 26761 Behrens Rd. Fairfax

CONTRACTOR'S PHONE NO. 782-7756

WATER TAP SIZE: = 1" () = 1-1/2" () = 2"

WATER METER s# _____

- New Dwelling () - Existing Dwelling

() - Lawn Meter

Water Service Line to be Type (K) Copper or (CTS) Polyethelene Tubing of one inch (1") minimum.

Watts No. 7 Dual check required = Yes () = No

Water Meter Yoke installation is subject to the following conditions:

- 1.) Must be located in an accessible area.
- 2.) Must be in an area not subject to freezing temperatures.
- 3.) Must be eighteen inches (18") above floor level, **not in crawl spaces.**
- 4.) Must comply with the mounting criteria and clearances as set forth in **DRAWING #04403901.**

10-11-95

Kahl-Bldgs,

1120 Becca

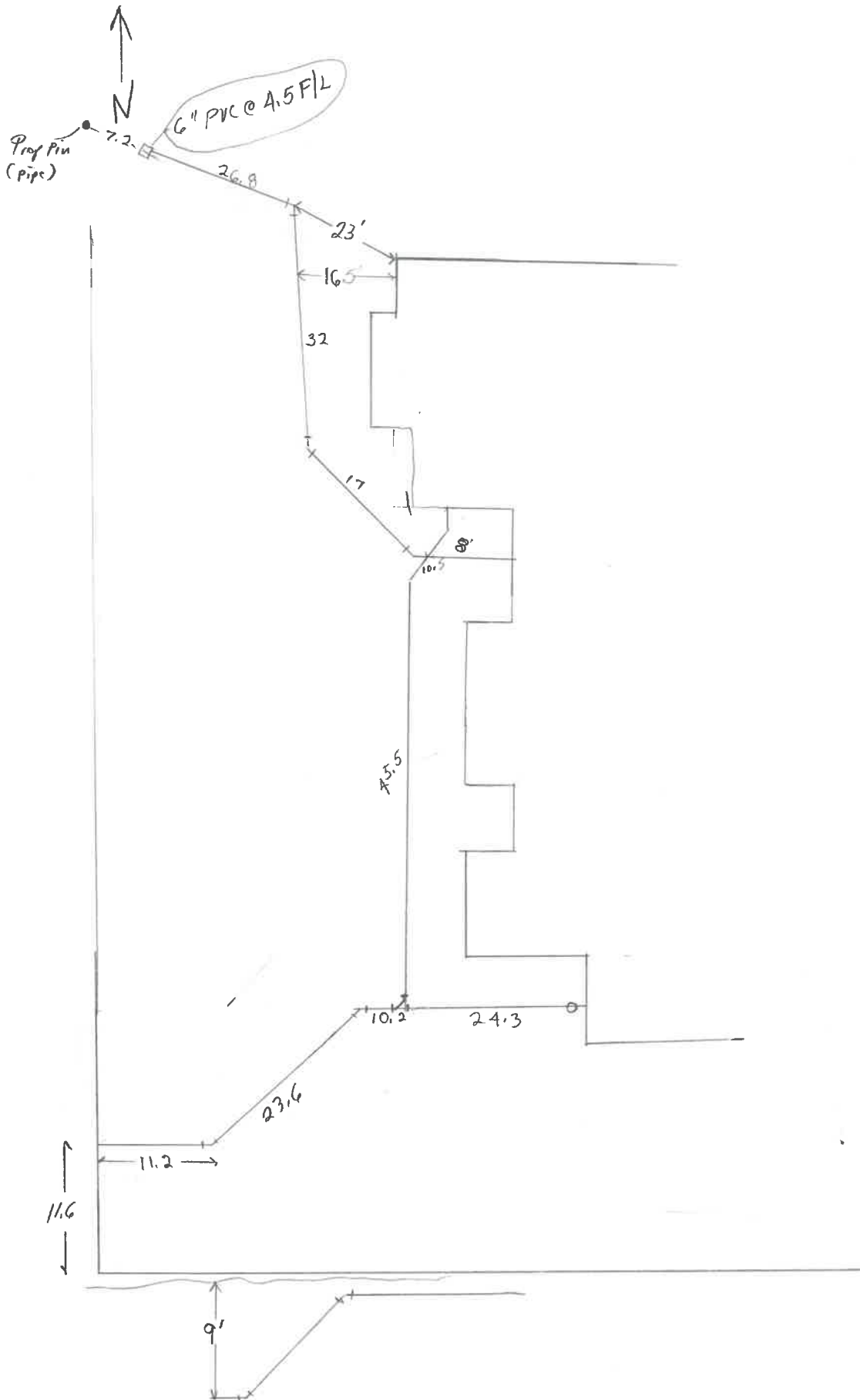

WATER TAPPING PERMIT

issued by

The Napoleon Water Distribution Department

255 West Riverview Ave. Napoleon, Ohio 43545 Ph. 592-4010

Permit No. W-0617

Issued 7-12-95

Received of Ralph B. Butler

(\$ 650) .00

(Charge for tapping permit to supply water service to) Lot No. 33

Sub Div. Twin Oaks 2nd

Street No. 1120 Becca Ln

Tap Size 1

Cost \$.00

Plumber Same

Date completed

Approved by

Jeffrey C. Mantugh
water distribution dept.

finance director

Name

Size of tap 1"

Date 10-16-95

Street and No. 1120 Becca Lane

Old Tap No. —

New Tap No. 9576

Size and Kind of Main 8" C-900

Location of Main 5' South of South Corp

Depth of Main 6'

Distance from Hydrant/Valve 114' East of Hyd #150

Distance to Curb Stop from Corp. 12 1/2'

